



ec-H2O NanoClean Water Conditioning Cartridge Kit

Models equipped with ec-H2O NanoClean Technology



The water conditioning cartridge is required to be replaced when it reaches its maximum water usage or expiration time of when the cartridge was activated, whichever comes first. The machine's control panel will signal a code when time has expired to replace cartridge (See *Operator Manual for further details*).

The cartridge is designed to protect the machine's ec-H2O NanoClean plumbing system from potential scaling.

Depending on machine usage a new cartridge can last up to 24 months.

Replacement cartridges are labeled with a manufacture date. The shelf-life of an un-installed cartridge is one year from manufacture date. Discard if shelf-life has expired.

INSTALLATION INSTRUCTIONS:

Installation Time: .5 Hours

FOR SAFETY: Before servicing machine, stop on level surface, turn off machine, and set parking brake if equipped.

1. Locate cartridge as shown below (Refer to *Operator Manual for further details*). Before removing old cartridge, take note to how the cartridge is oriented.



T300/e, Speed Scrub 300, A300



T5, T5e, Speed Scrub

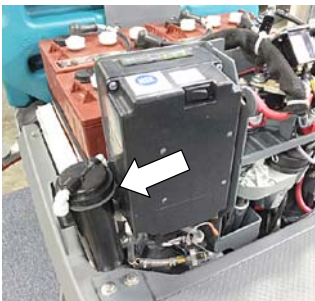

T7, Speed Scrub Rider



5680, 5700/XP

2. To disconnect the two hose connectors from cartridge, press the gray collars inward and pull the connectors outward. Dispose old cartridge.



Gray Collar



3. Fill in the installation date on the new cartridge label.



Plug (2)

Tab (2)

4. Remove the two plugs and install the new cartridge in the same orientation of the removed cartridge. Align the tabs with slots in holder to prevent the cartridge from rotating. Make sure the hose connectors are fully inserted into the cartridge.
5. Reset timer on ec-H2O module for new cartridge.

Carefully read and understand the following steps before performing procedure.

- a. Turn key on.
- b. Press and hold the service switch, located on the ec-H2O module, for 10 seconds. After releasing service switch, the three solution flow indicator lights will begin to (ripple) move back and forth.
- c. Within 5 seconds after releasing the service switch, while the three indicator lights are moving back and forth, press and quickly release the solution flow button located on ec-H2O module. The three indicator lights will then blink three times to indicate timer has been reset.

Repeat process if the three indicator lights do not blink three times.



Service switch

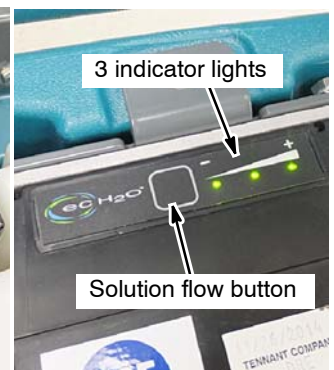

3 indicator lights

Solution flow button

ATTENTION: After replacing the water conditioning cartridge, the ec-H2O system will automatically override the selected solution flow rate for up to 75 minutes.